



# WEST RAYNHAM SCHOOL COMPLEX

WEST RAYNHAM

A rare opportunity has arisen to occupy part of a unique premises in West Raynham

The main block of the school dates back to 1854 and has been added to over the years.

The complex also has additional buildings to the rear and 0.8 Acres of green space

The current layout comprises of

- Main block 2111.9 SqFt
- Side classroom 873.6 SqFt
- Rear standalone office 171.5 SqFt
- Rear standalone classroom 935.8 SqFt
- Pergola 541.6 SqFt





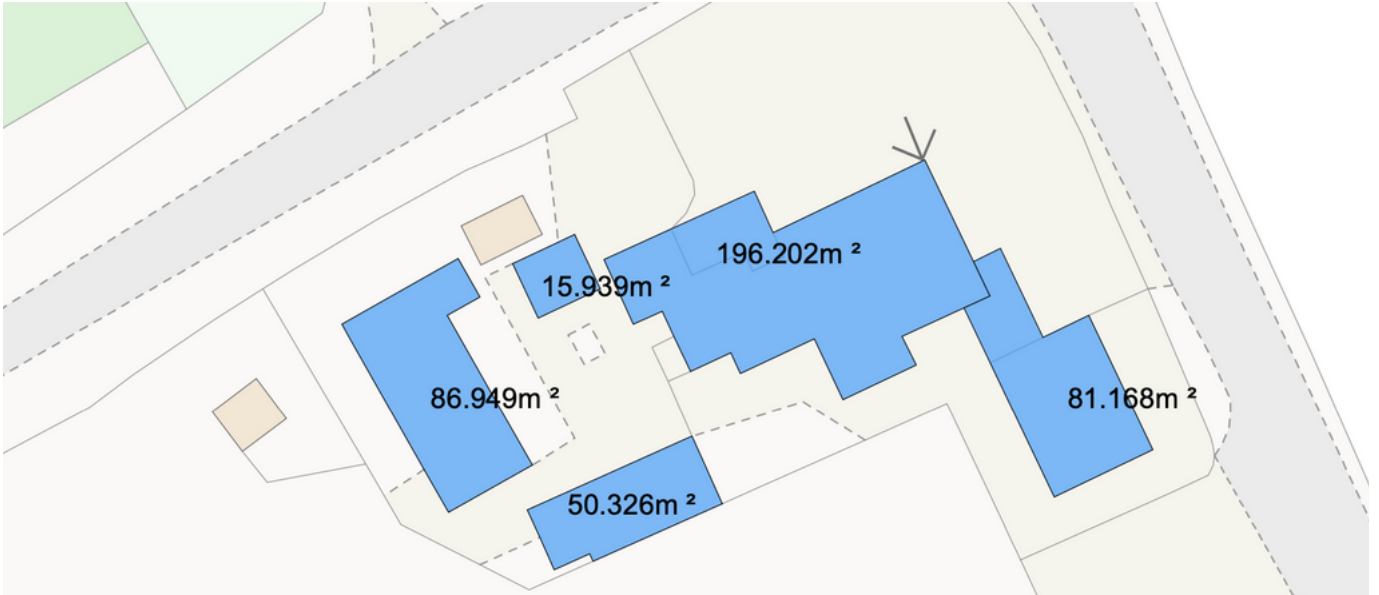

Viewing is strictly by appointment only. To arrange an appointment to view or for enquiries please contact Abbie on 01328 863746 or via [abbie@raynham.co.uk](mailto:abbie@raynham.co.uk)

Raynham Farm gives notice that:

- a) The particulars are set out as a general outline only for the guidance of intending purchasers or lessees and do not constitute, nor constitute a part of, an offer or a contract;
- b) All descriptions, dimensions, reference to condition and necessary permissions for use and occupation, and other details are given without responsibility and any intending purchasers or tenants should not rely on them as statements or representations of fact but must satisfy themselves by inspection or otherwise as to the correctness of each of them.